

(replaces datasheets 1011/81 / 89 / 94 / 145 / 146)

General description

A range of manually operated fog/jet water/foam monitors with exceptional flow characteristics, optimising throw range with delivery of water or foam in jet form or as a spray pattern. The range is available for a number of alternate mounting positions, with two main types: the FJM and FJM-S, where the 'S' version has an in-built foam concentrate inductor, eliminating the need for a separate proportioning system.

Application description

The range of fog/jet monitors are designed for easy operation, reliability in use and over time and lower weight, due to the selection of build materials employed.

FJM monitors have a wide operating range, site adjustable for maximum flexibility to take local conditions into account and still maintain the highest level of performance.

Note that when running any of the FJM range of monitors, the monitor needs to be adjusted to nominal capacity for accurate proportioning.

Product features

- Wide flow range
- Adjustable flow
- Compact balanced design
- Low weight
- Easily manoeuvred due to low friction bearings
- Long throw length
- Adjustable stream pattern
- Corrosion resistant construction

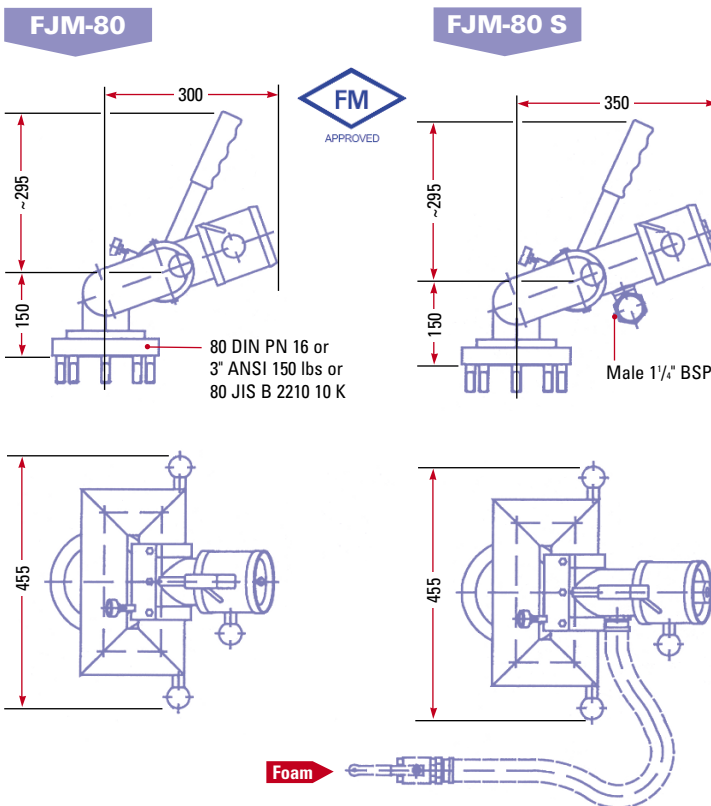

FJM-80 Monitor - Range of Jet

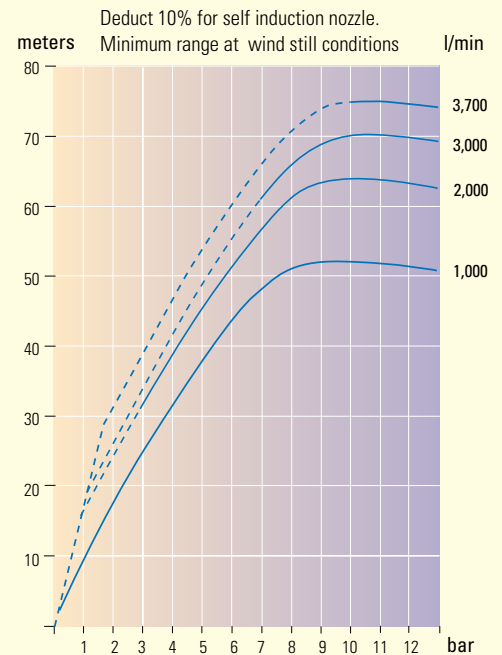

$$\text{Reaction force (N)} = 0.233 \times Q \text{ (l/min)} \times \sqrt{p \text{ (bar)}}$$



www.skum.com

tyco Fire Suppression
& Building Products

(replaces datasheets 1011/81 / 89 / 94 / 145 / 146)



FJM-100



FJM-100 S

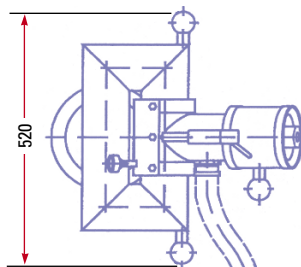
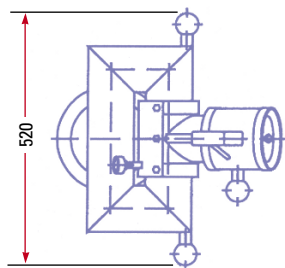
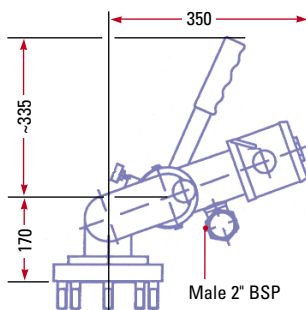
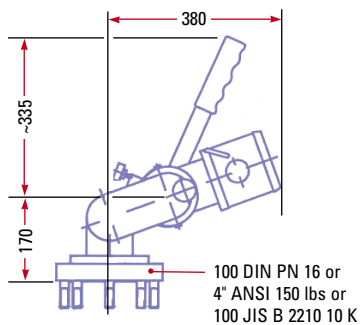

FJM-100 Monitor - Range of Jet

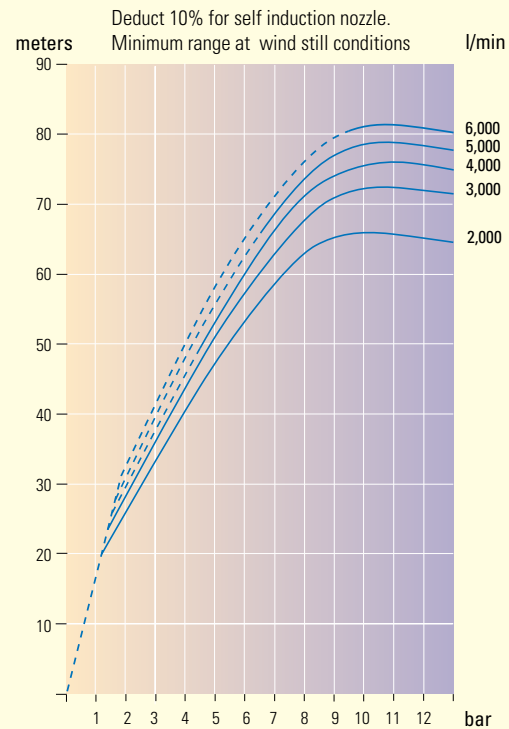

$$\text{Reaction force (N)} = 0.233 \times Q \text{ (l/min)} \times \sqrt{p \text{ (bar)}}$$

Connections

- Main flow connections: flanged according to DIN PN 16 or ANSI 150 lbs
- Built-in inductor for all models ("S" version)
- Gear operation; optional for FJM-150, standard for FJM-200
- Suction hose and valve

Listings and approvals

- Classification societies; DNV; Lloyd's Rina; BV
- Factory Mutual approval for: FJM-80; FJM-100; FJM-150; FJM-200

FJM Monitors - Average Fog Pattern (in still air)

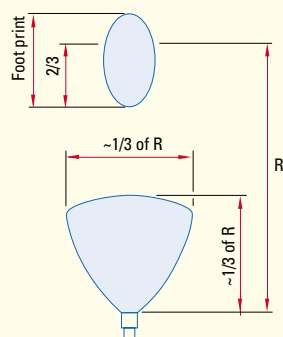

Technical Data				
FJM Series - Standard	80	100	150	200
Water capacity	3,000 l/min	6,000 l/min	11,700 l/min	20,000 l/min
Design pressure	16 bar	16 bar	16 bar	13 bar
Rotation	360°	360°	360°	360°
Elevation	-60° / +90°	-60° / +90°	-60° / +70°	-60° / +70°
Connection flange	Stud bolt	Stud bolt	Open hole	Open hole
Weight	14 kg / 31 lbs	22 kg / 49 lbs	57 kg / 126 lbs	90 kg / 199 lbs

Technical Data				
FJM-S Series - Built-in inductor	80	100	150	200
Water capacity	3,000 l/min	6,000 l/min	11,700 l/min	20,000 l/min
Foam capacity	170 l/min	320 l/min	600 l/min	600 l/min
Elevation	-45° / +90°	-45° / +90°	-45° / +70°	-45° / +70°
Suction connection	1 1/2" BSP male	2" BSP male	2" BSP male	2" BSP male
Weight	15 kg / 33 lbs	24 kg / 53 lbs	60 kg / 132 lbs	93 kg / 205 lbs



Fog/Jet Monitor - Manual

FJM-MAN

(replaces datasheets 1011/81 / 89 / 94 / 145 / 146)

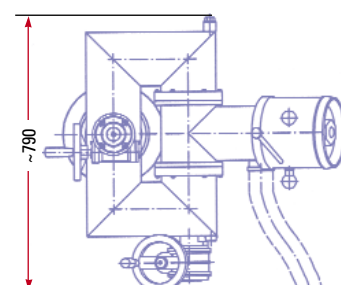
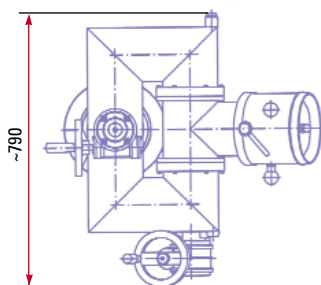
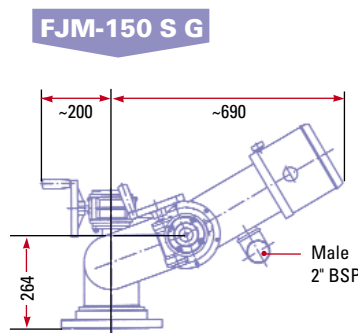
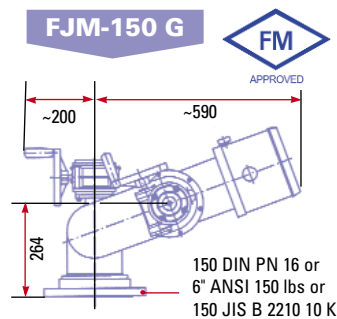
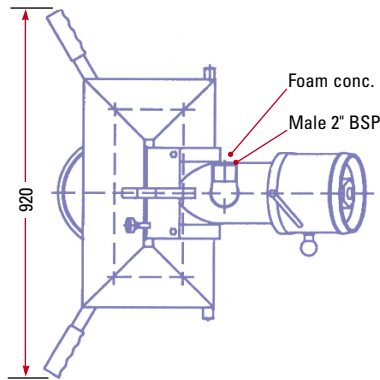
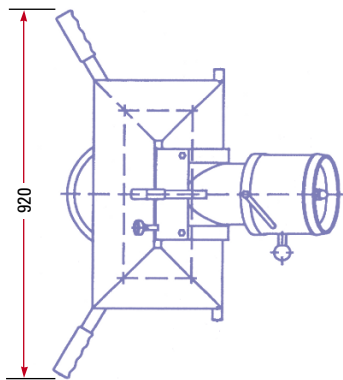
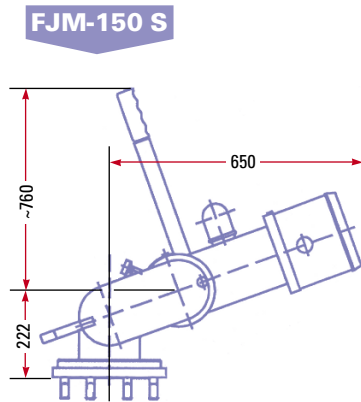
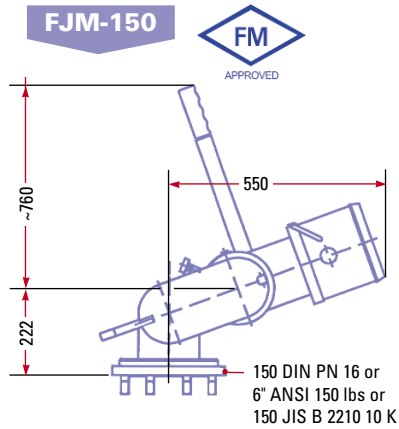

FJM-150 Monitor - Range of Jet

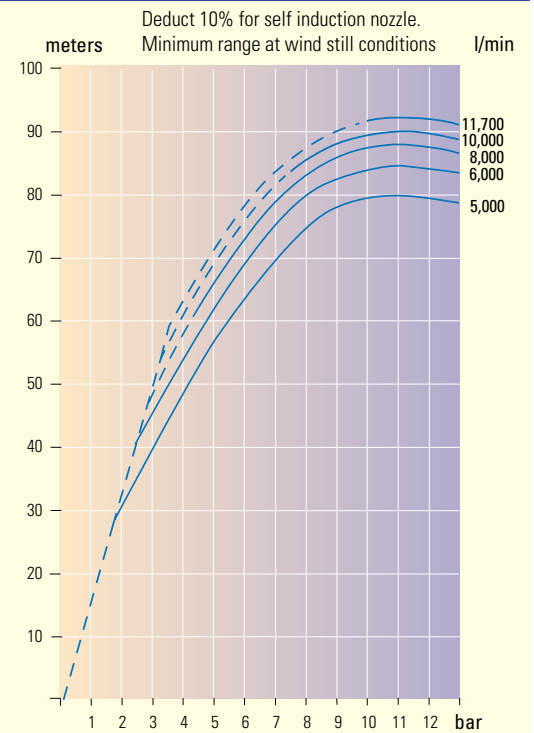

www.skum.com

tyco Fire Suppression
& Building Products

(replaces datasheets 1011/81 / 89 / 94 / 145 / 146)

FJM-200 G

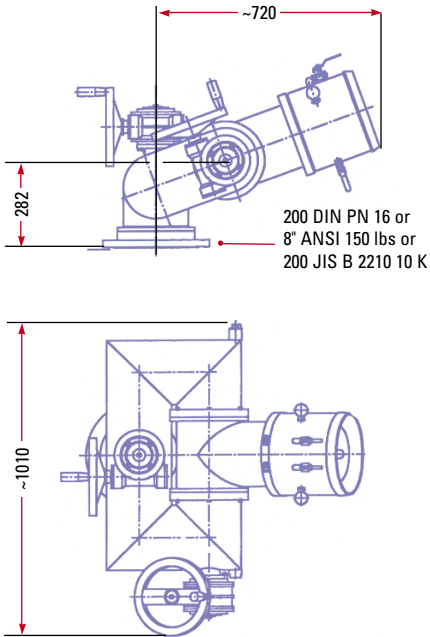

FJM-200 SG

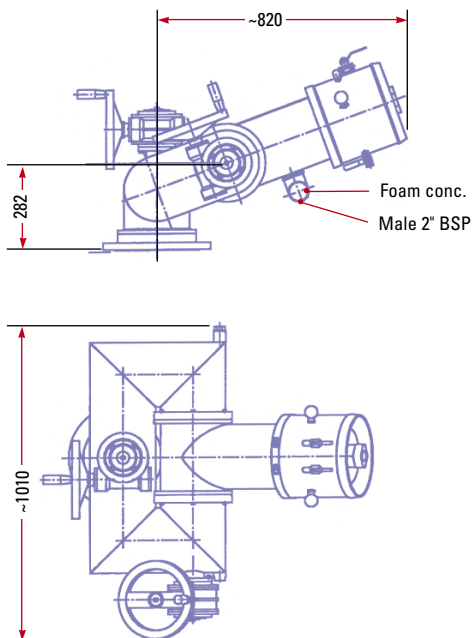

FJM-200 Monitor - Range of Jet

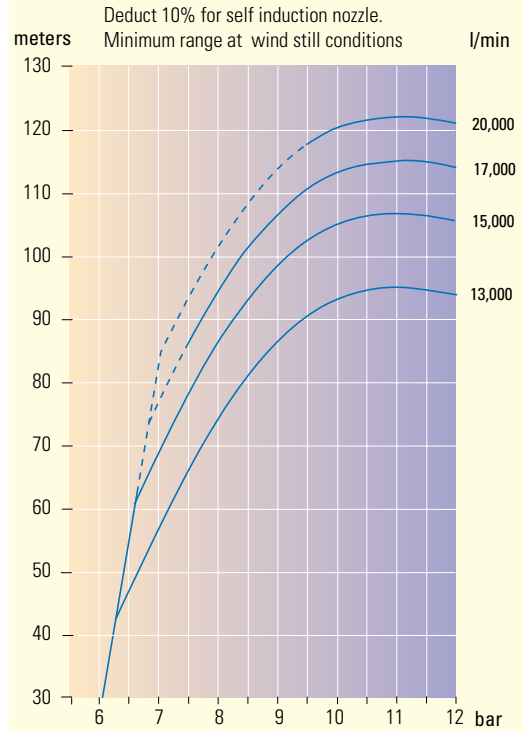

$$\text{Reaction force (N)} = 0.233 \times Q (\text{l/min}) \times \sqrt{p (\text{bar})}$$

FJM Monitors - Capacity Ranges

